

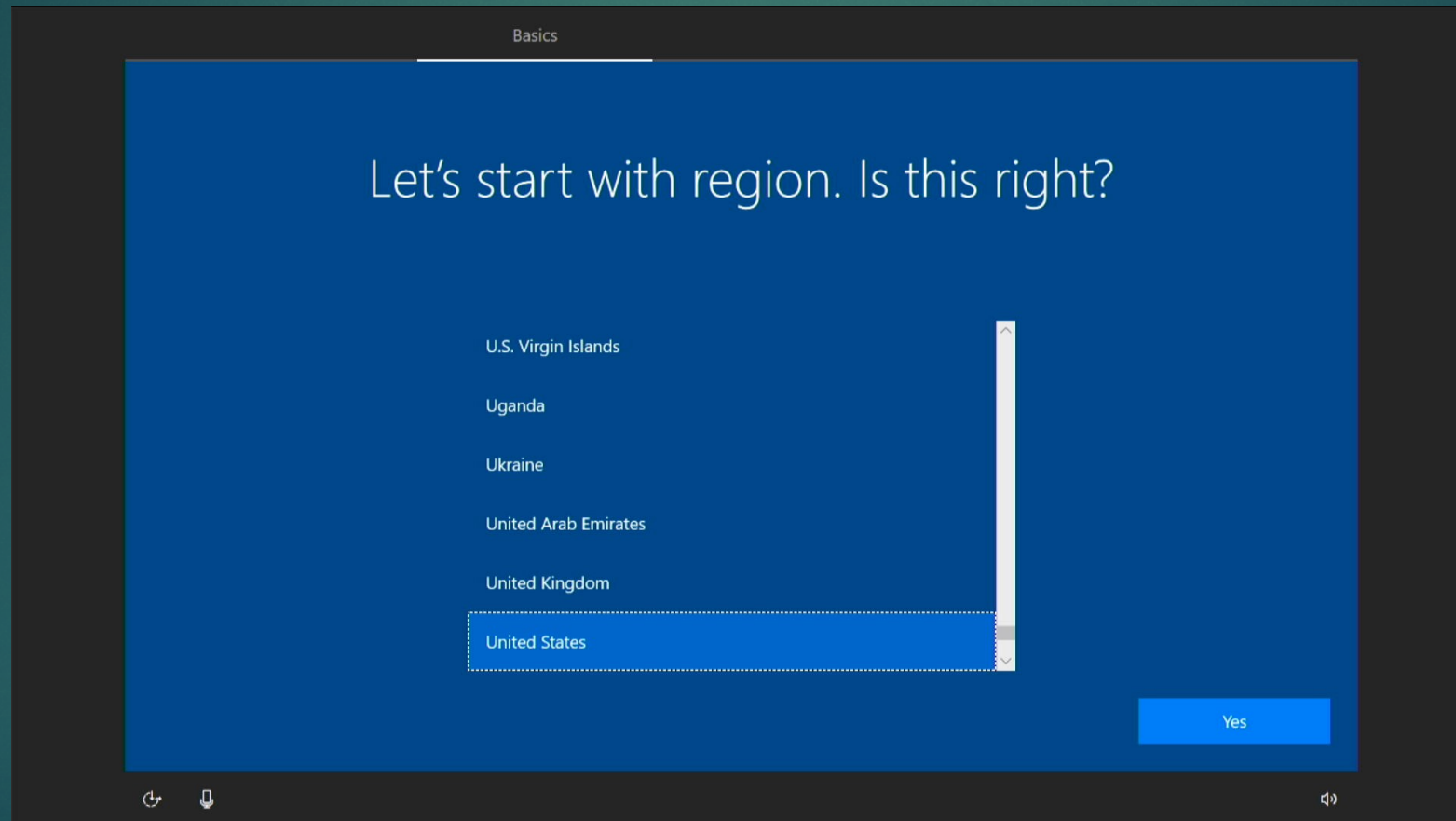

Onboarding Laptop with Intune AutoPilot from School

Turn on Laptop and on the region Selection Screen choose “United States. Then click “Yes”



Select “US” for the Keyboard Layout and click “Yes”

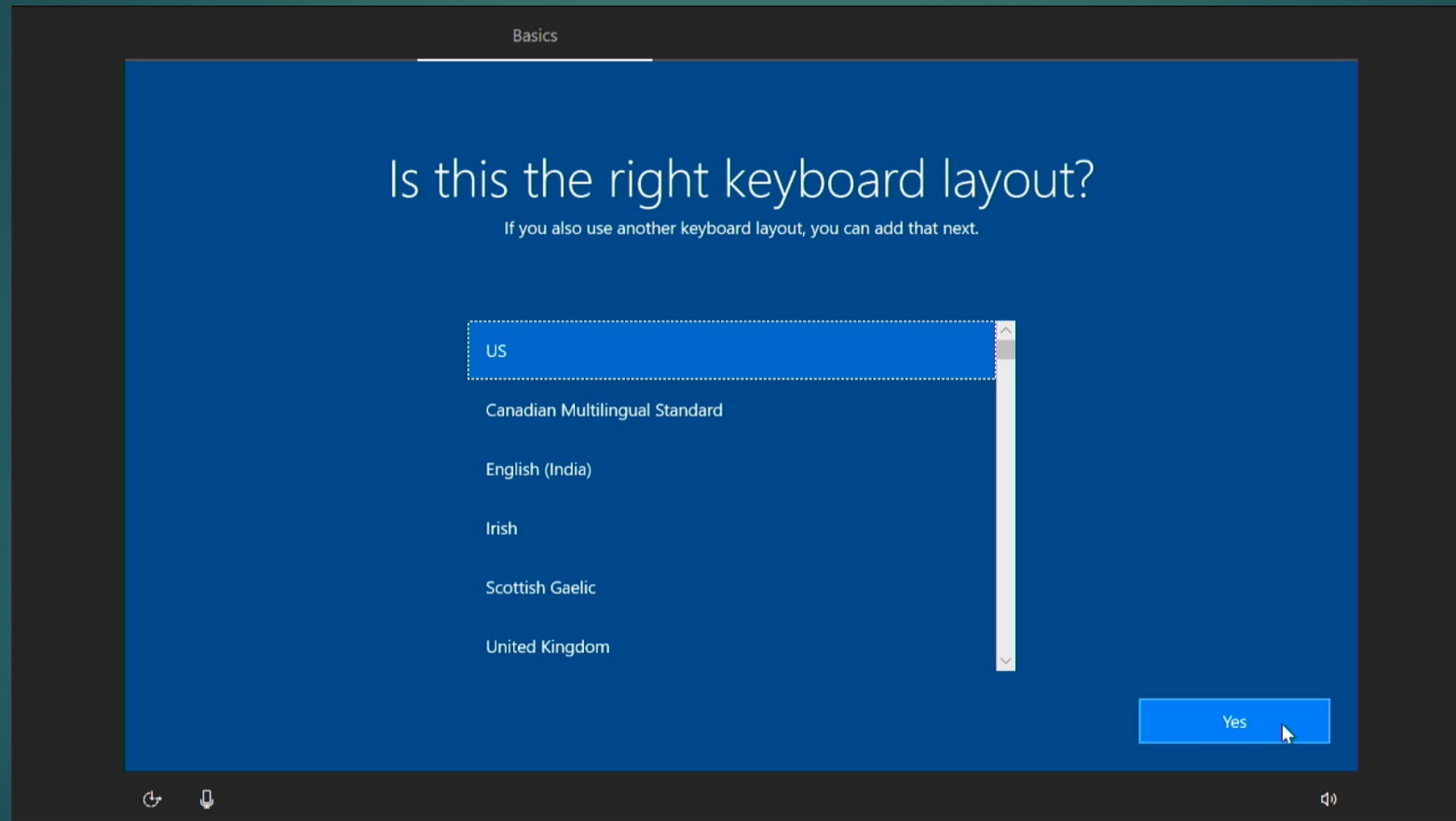

Choose “Skip” when asked for a second keyboard layout.

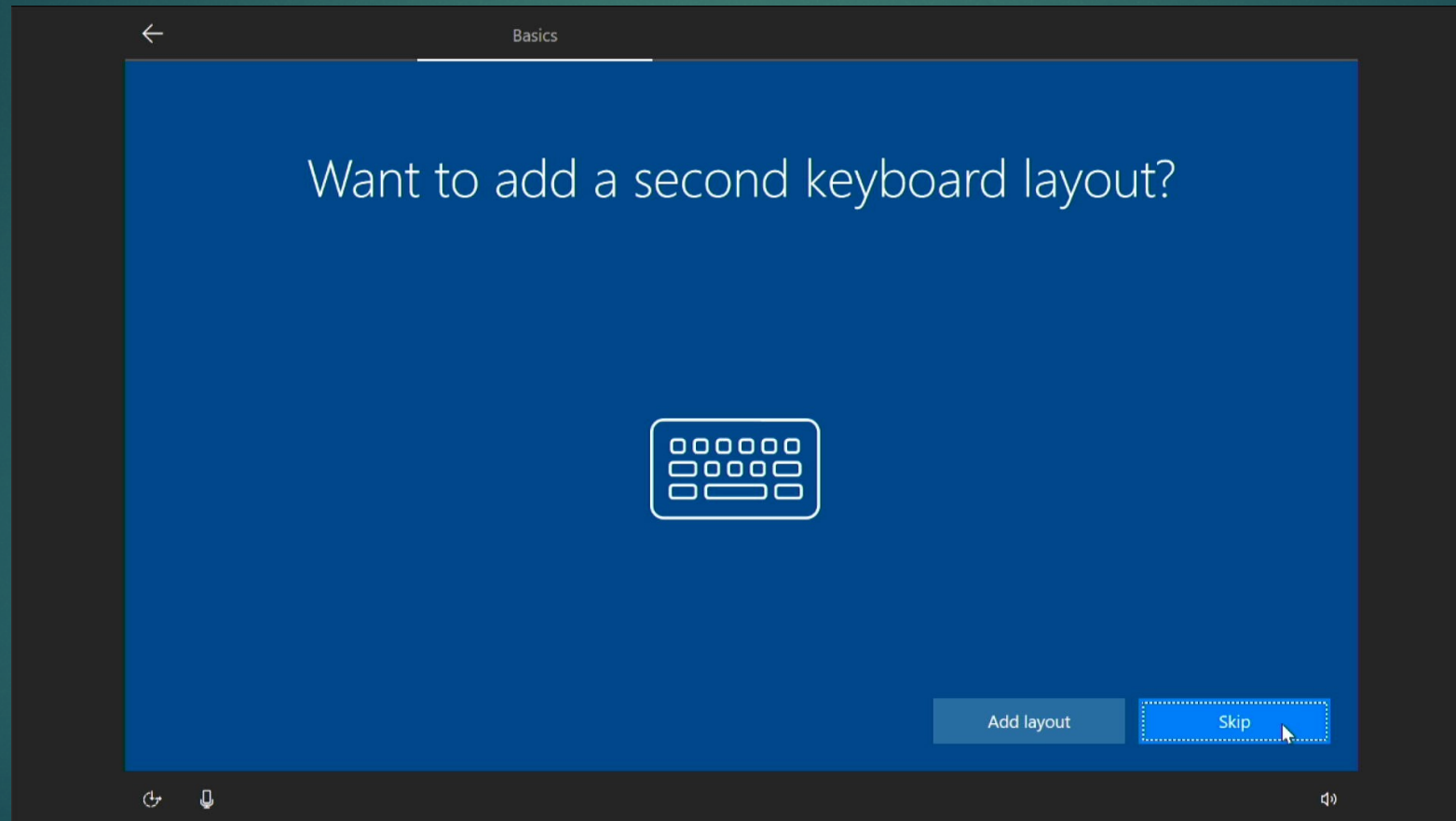

Select "SLPS-Enroll", make sure "Connect Automatically" is checked and click "Connect"

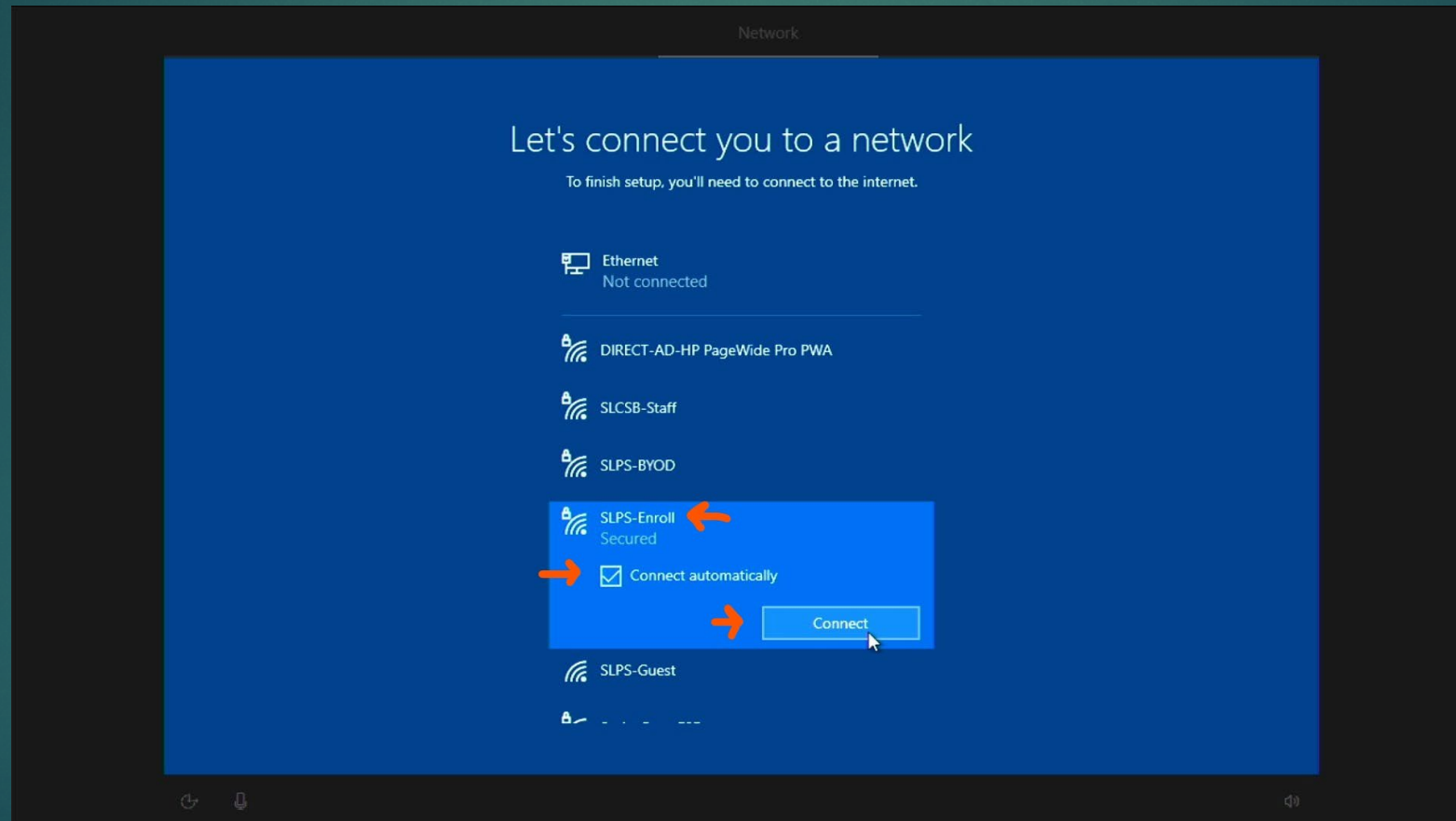

Type **EnrollDevice** as the password and click “Next”

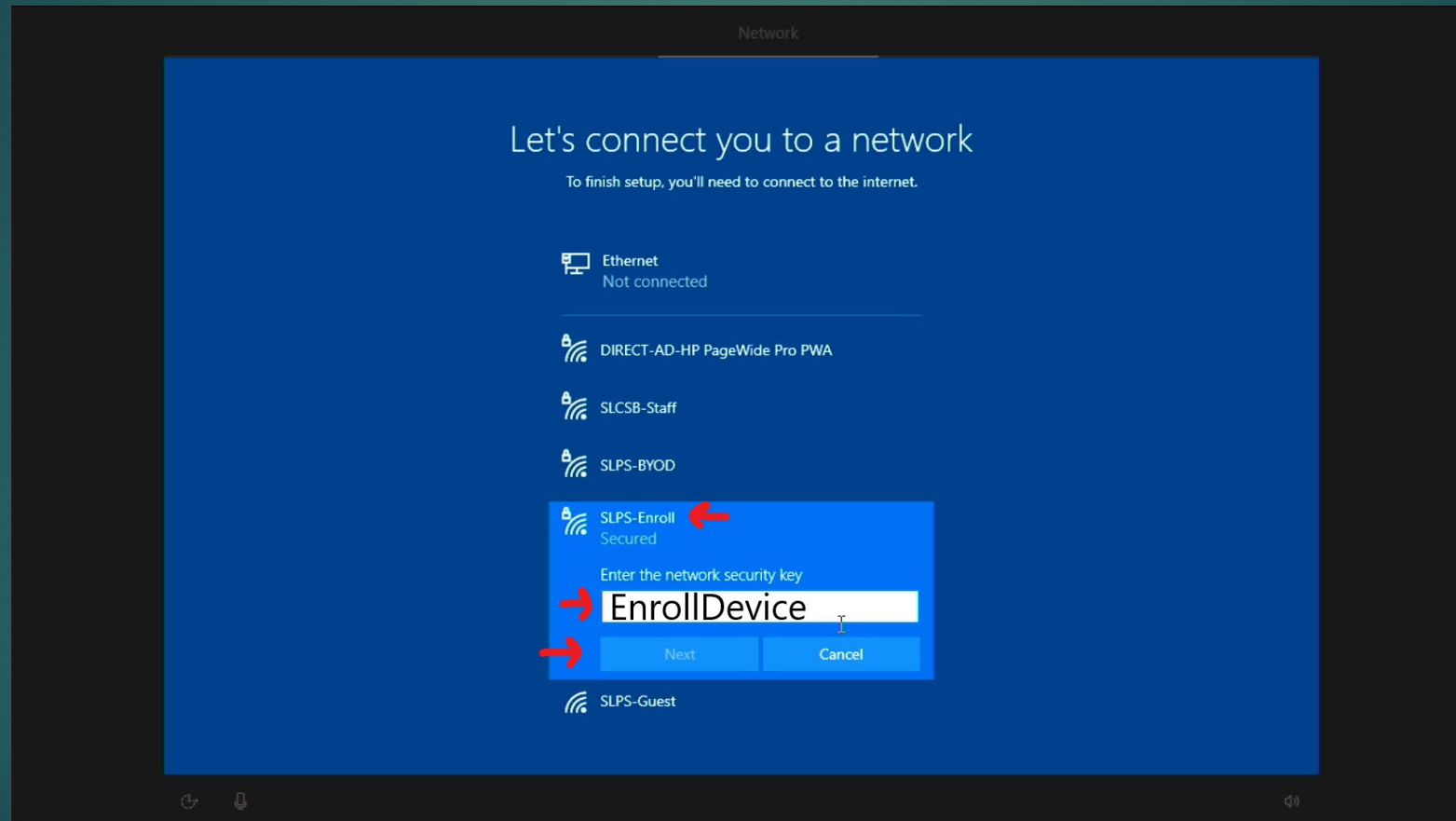

Click “Yes” and “Next”

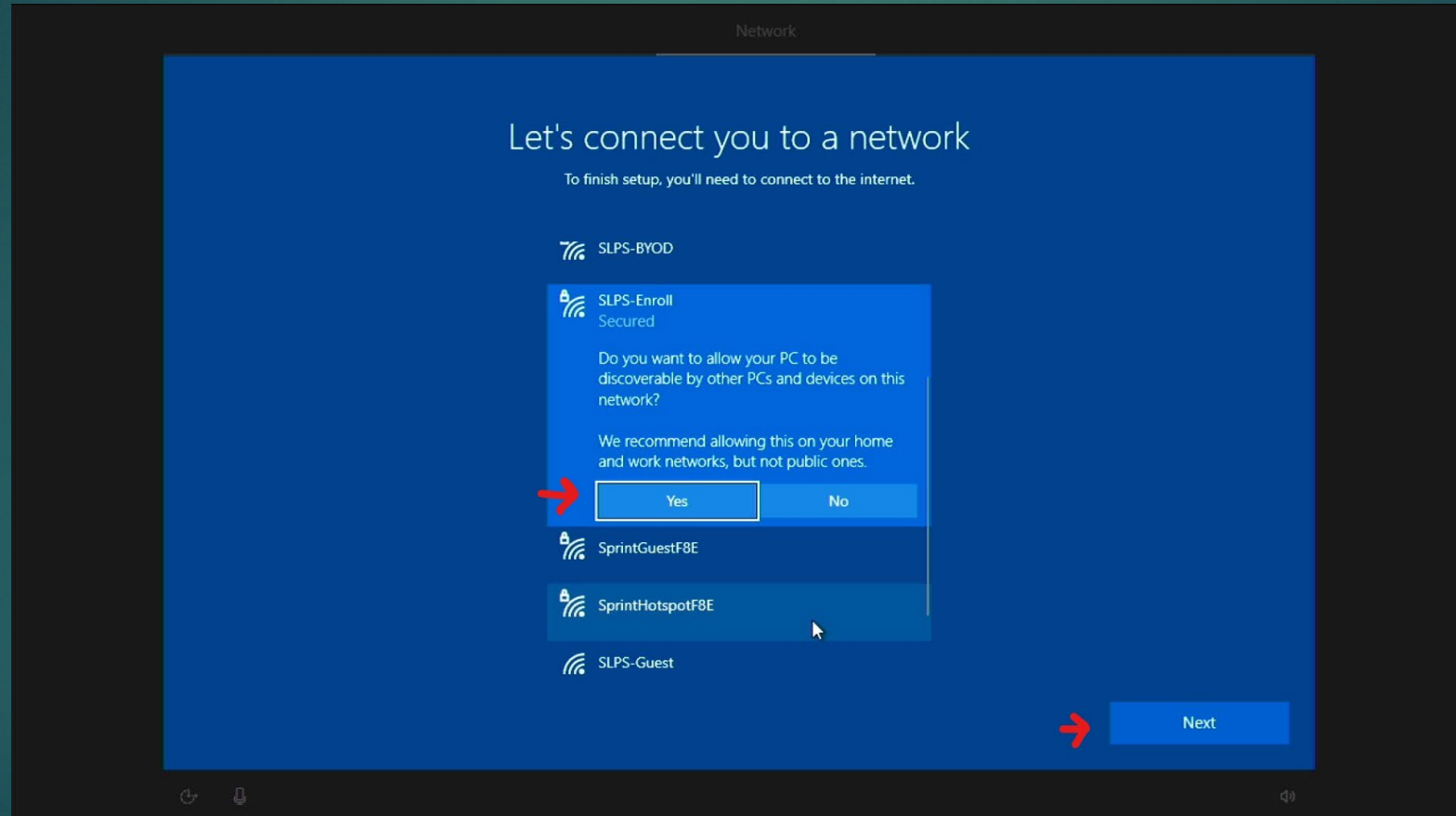

The laptop will make an initial connection with Intune and reboot.

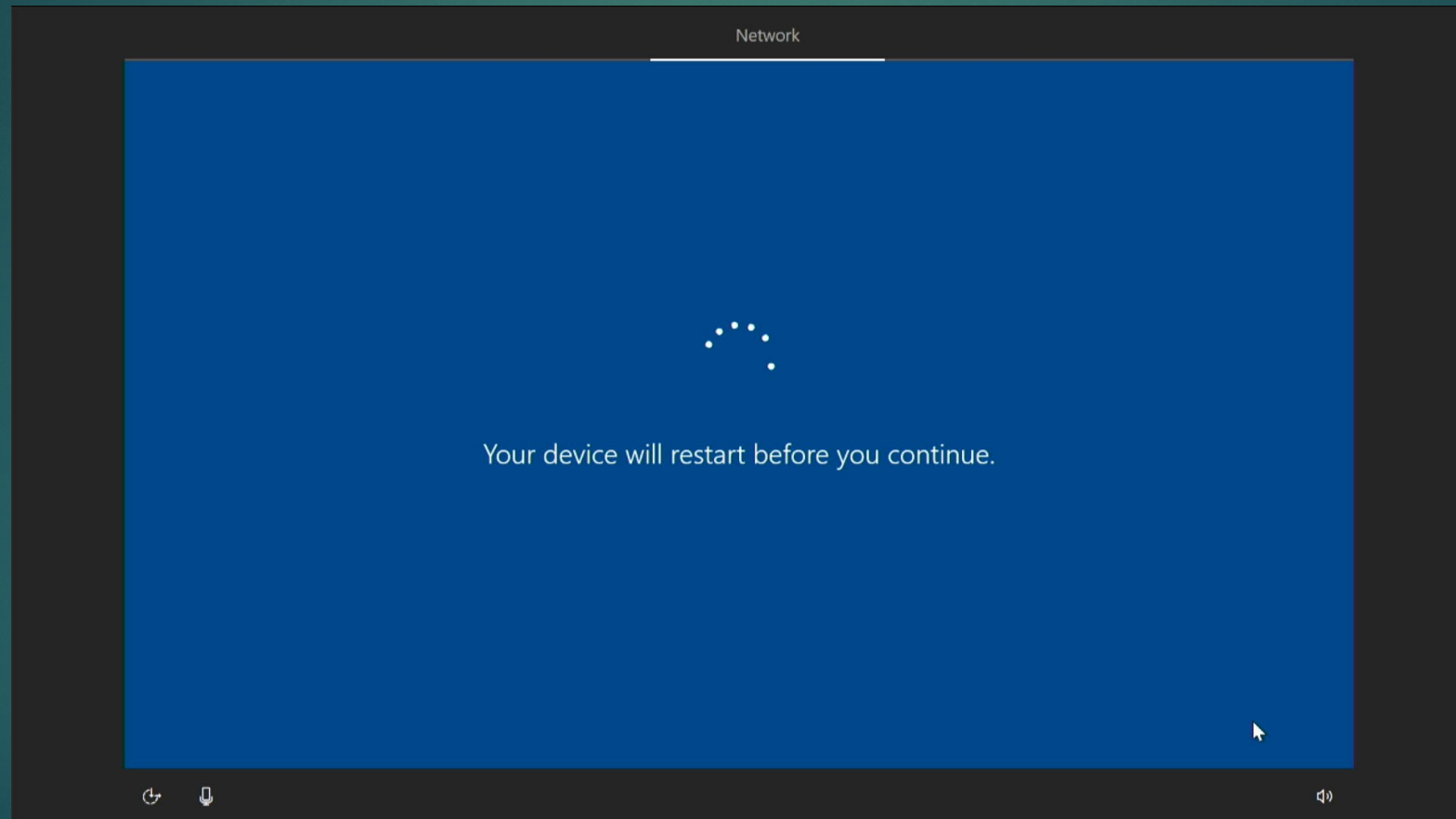

After the reboot a login page will load. Type in the users full email address and click “Next”

Email: 562*****@stlucieschools.org or first.lastname@stlucieschools.org

Account

Welcome to St. Lucie Public Schools!

Enter your St. Lucie Public Schools email.

Which account should I use?

Sign in with the username and password you use with Office 365 or other business services from Microsoft.

[Privacy & cookies](#) [Terms of use](#)

[Back](#) [Next](#)

Re-enter the credentials and click “Sign in”

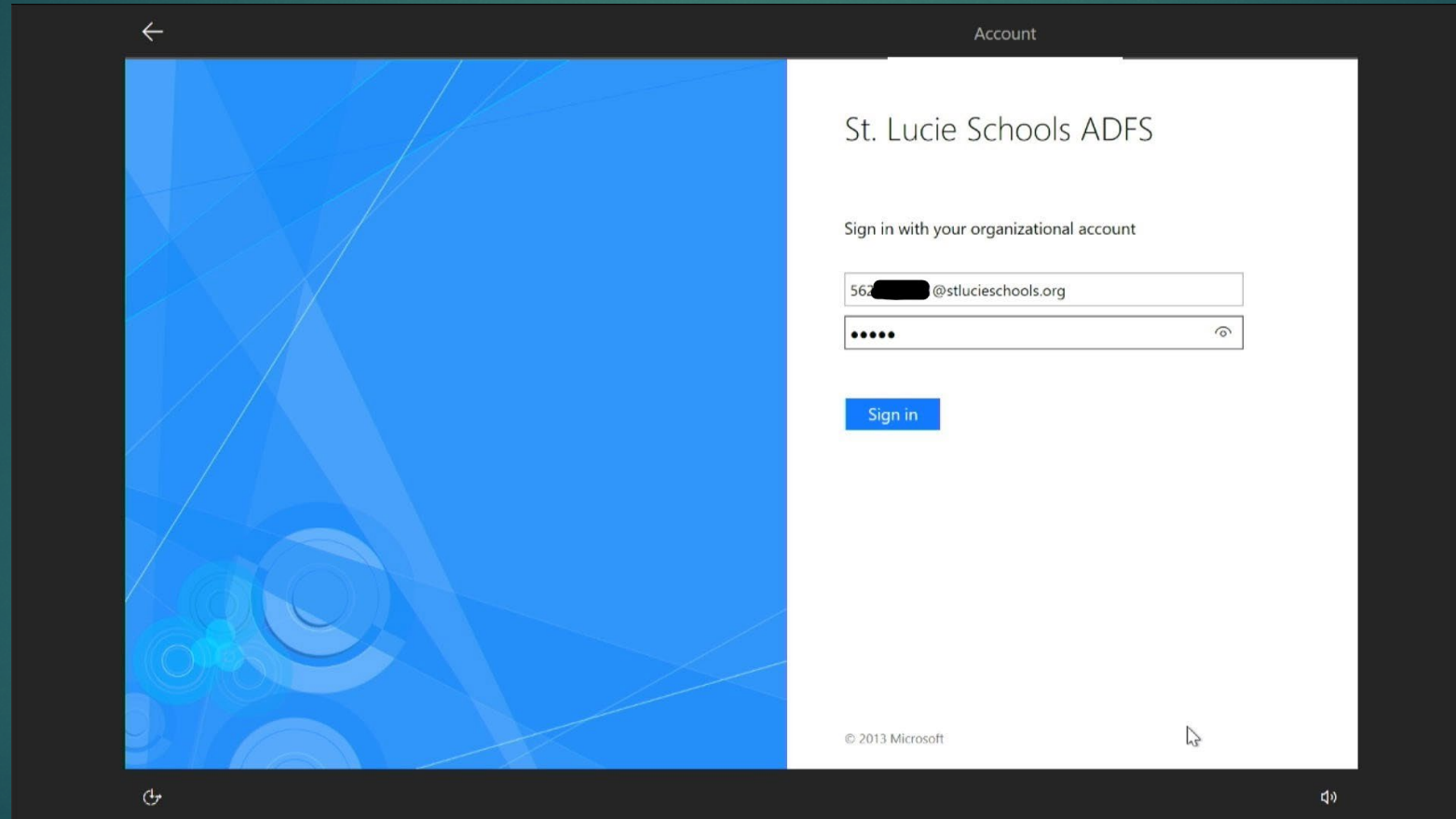

At this point the onboarding process will begin. During this process critical configurations and applications will be installed. The computer will also reboot multiple times.

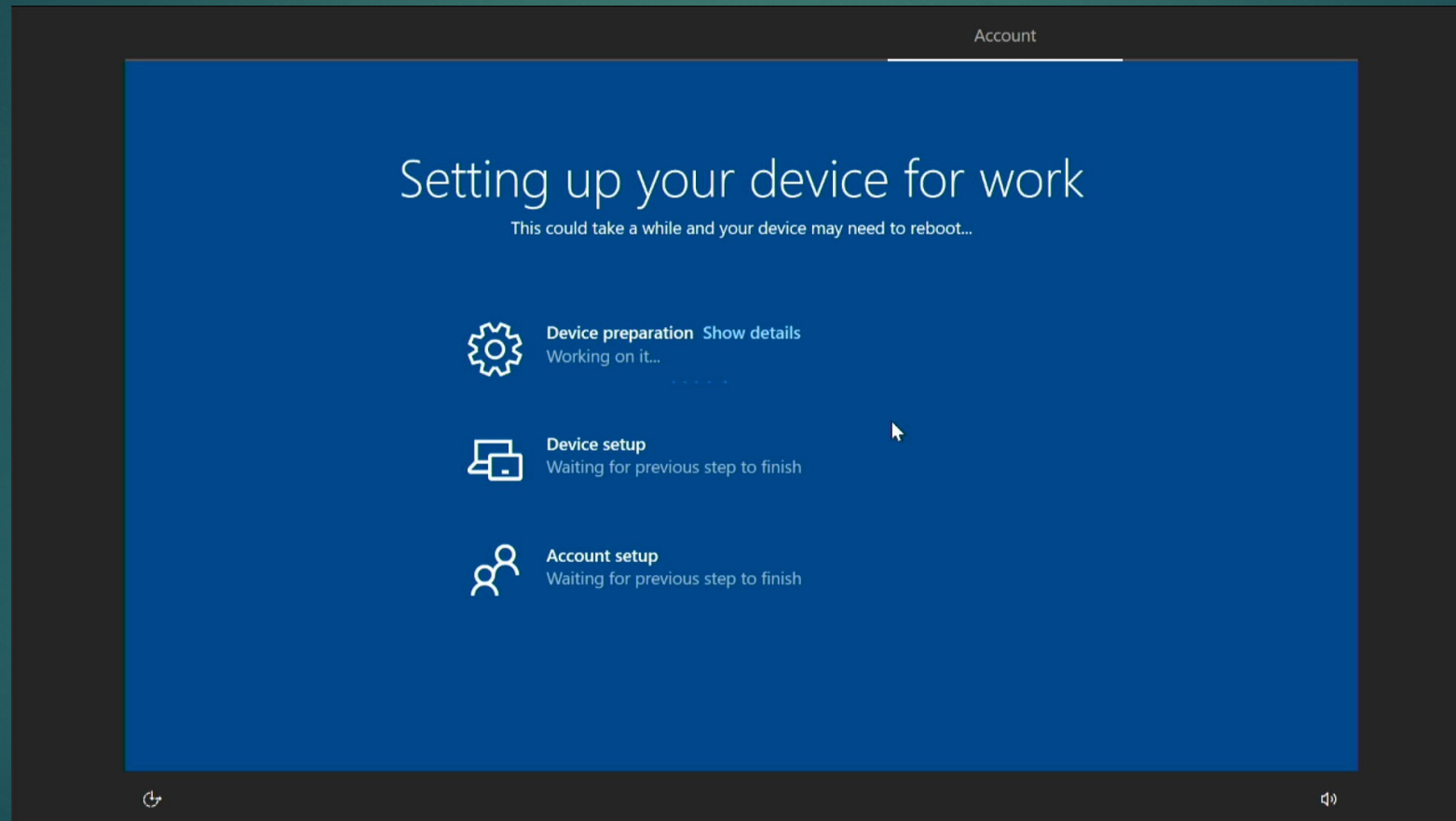

After the last reboot, click “Ok” on the SLCSB AUP

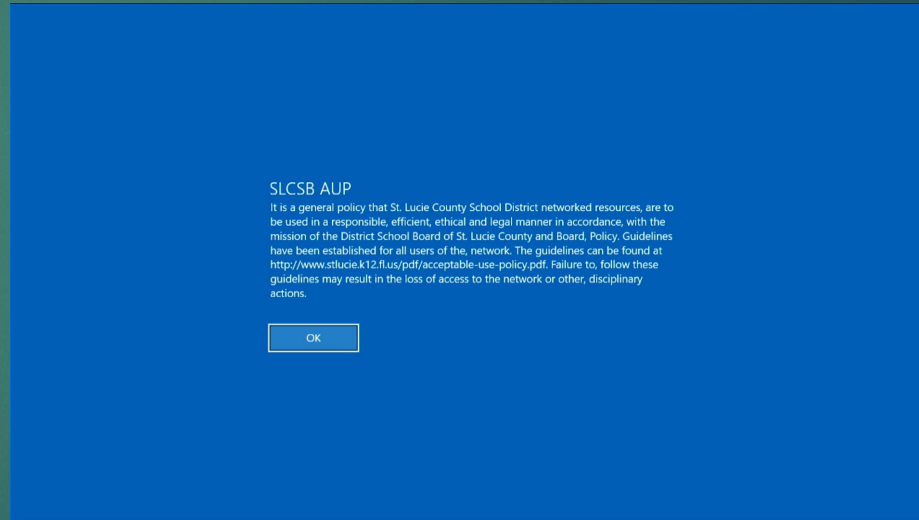
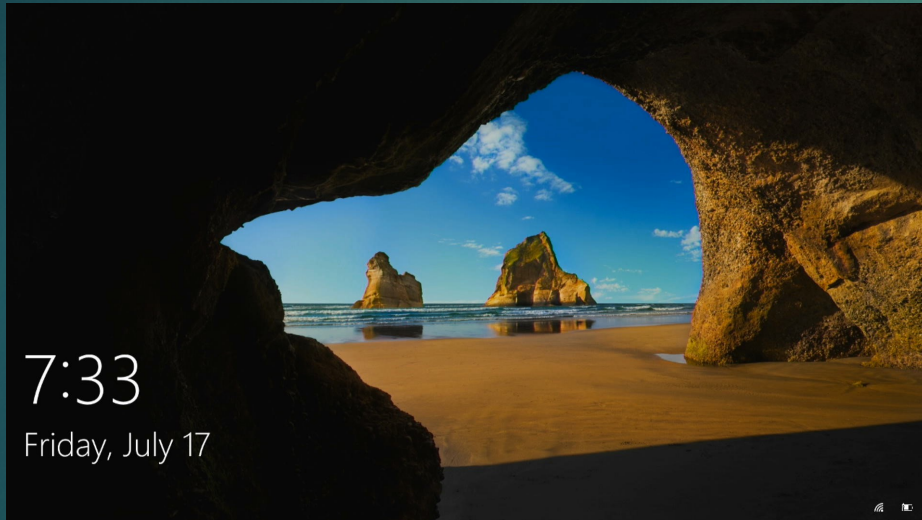

Type in the user credentials and press “Enter”

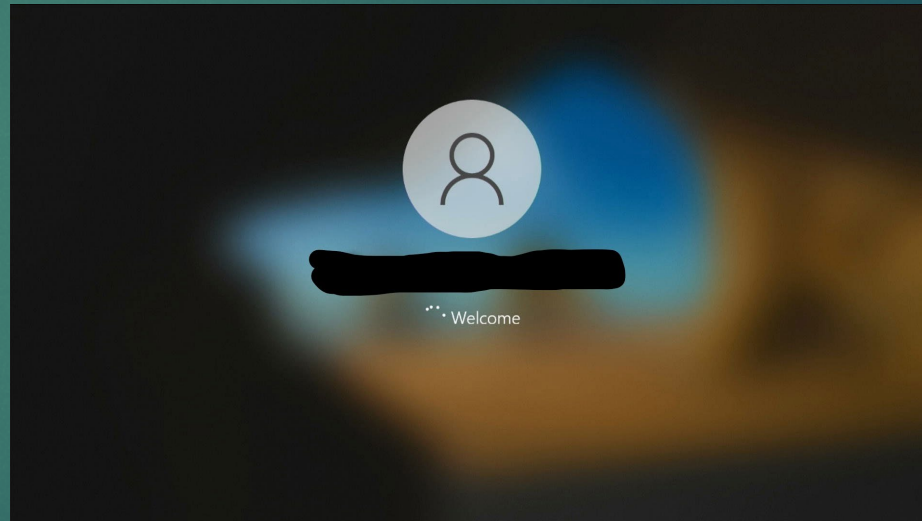
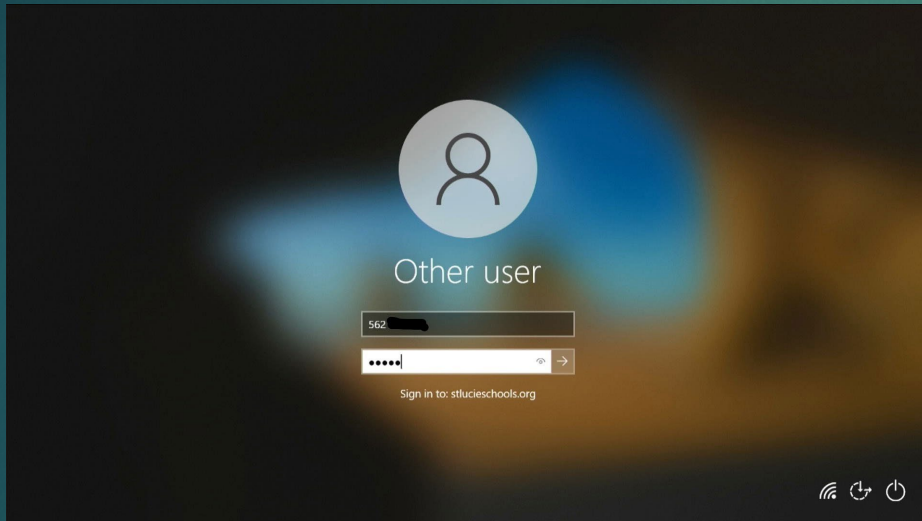

The status page will indicate that the setup process has completed.

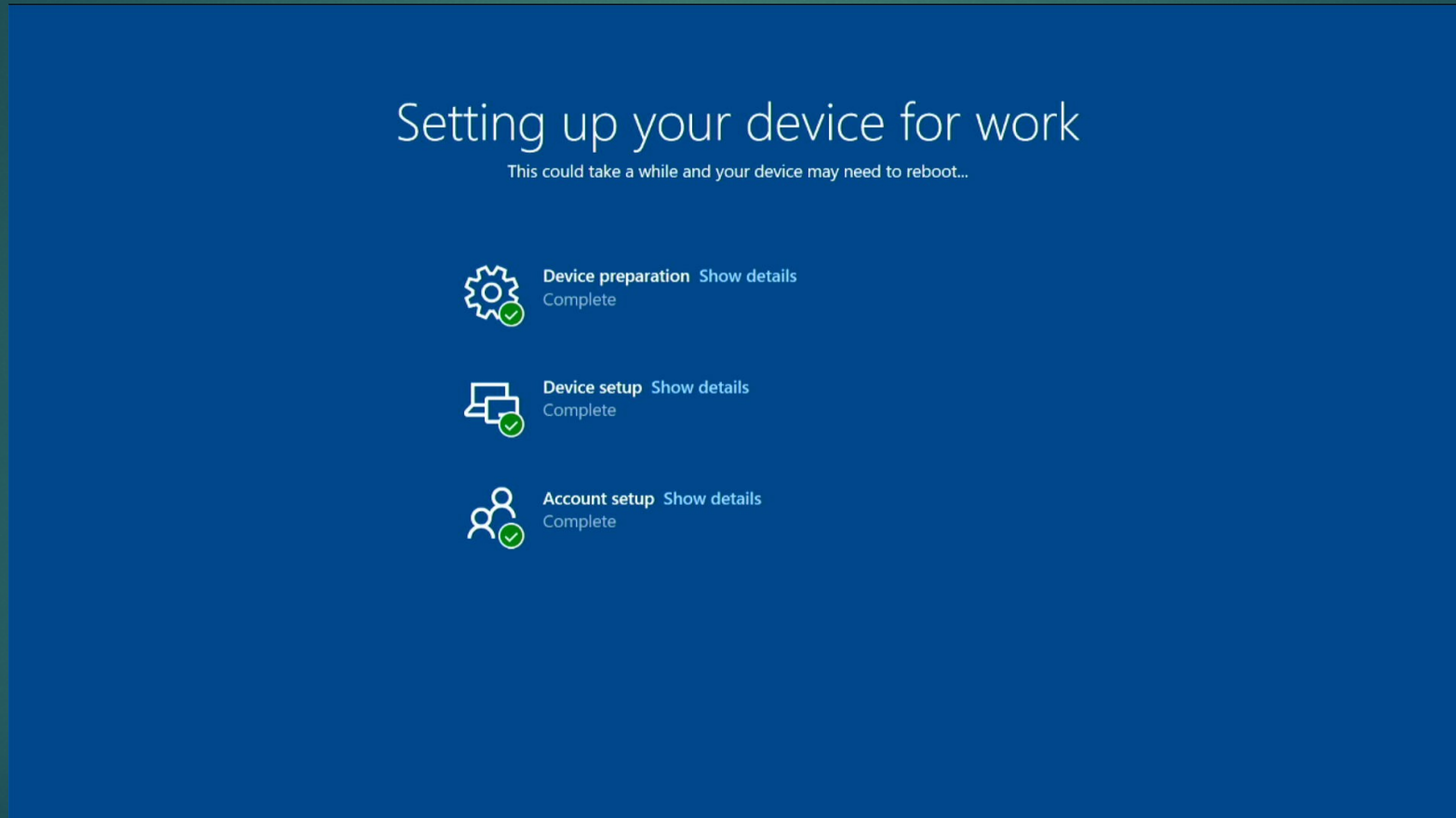

The laptop will load the Desktop and be ready for use. During this time additional applications will be installed in the background.

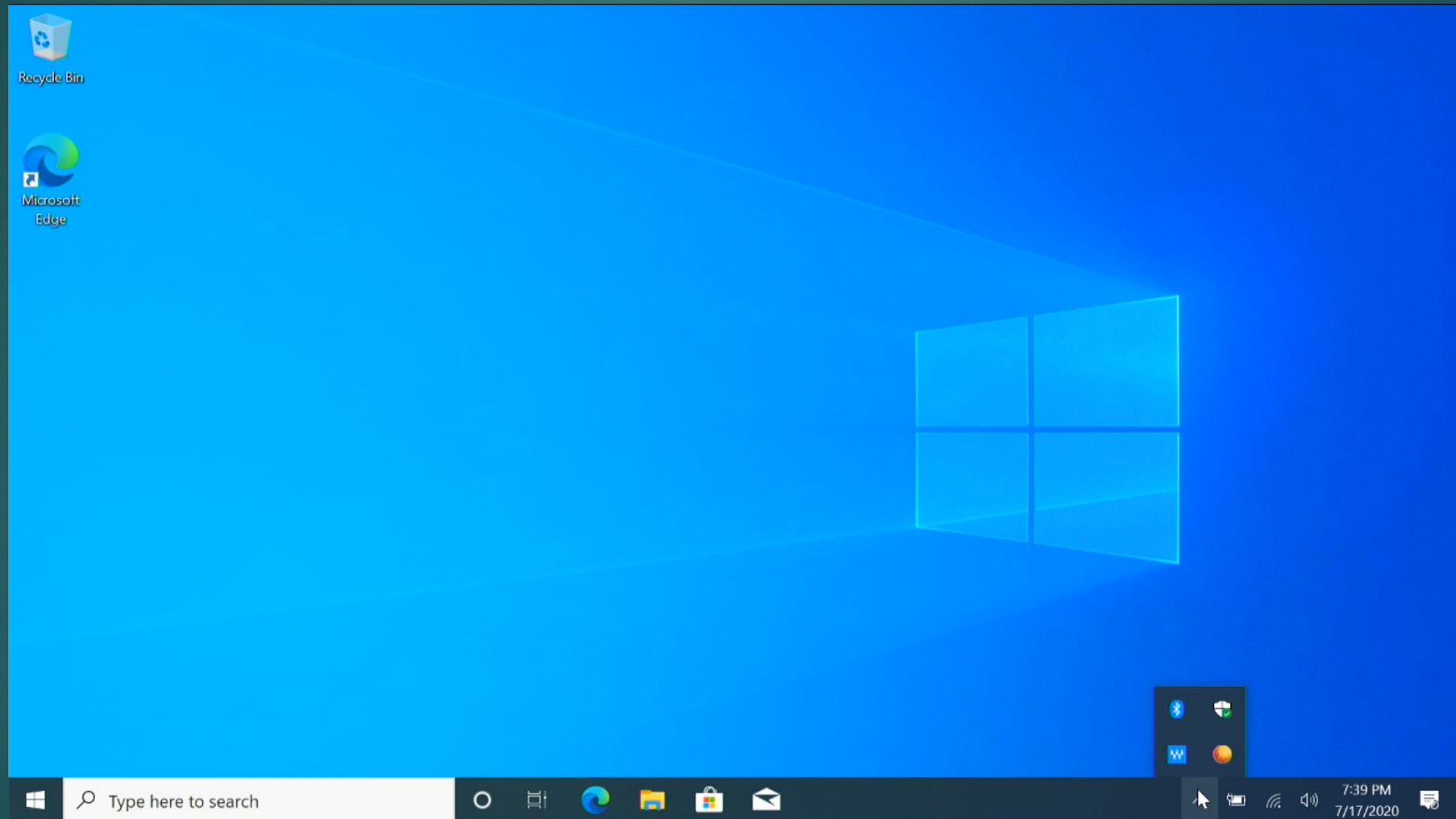

The laptop will switch from SLPS-Enroll SSID to another SLPS-Intune SSID.

